

STANDARD CONSTRUCTION JOINT DETAILS – TRAFFIC BEARING SLABS

Not subject to hydrostatic pressure

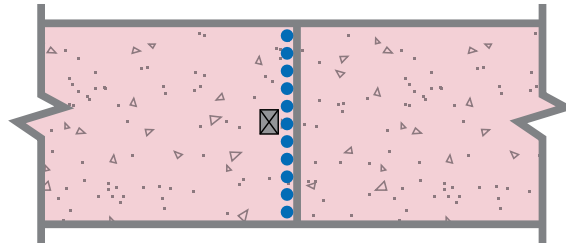

Subject to hydrostatic pressure

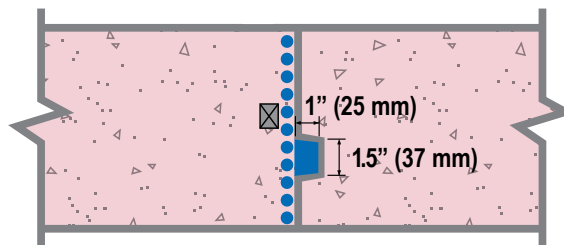

..... CONCENTRATE SLURRY COAT
 ■ CONCENTRATE DRY-PAC
 ■ ADMIX
 ⊗ WATERSTOP

STEP 1: On the bulkhead formwork modify the forms to create a linear groove in the finished concrete surface. The linear groove is to be included at all construction joints. The linear groove is to be 1½" (37 mm) high by 1" (25 mm) deep. Position the linear groove to be closer to the wet side of the element.

STEP 2: Pour Xypex Admix treated concrete and cure in accordance with ACI, EN or other accepted quality concreting authority. Strip forms including formwork for linear groove.

STEP 3: Clean joints, including linear groove, thoroughly. Apply Xypex Concentrate slurry to linear groove at the rate of 1.5 lb./sq.yd. (0.8 kg/m²). Fill linear groove with Xypex Concentrate Dry-Pac and pack tightly to create the Xypex "sealing strip".

STEP 4: Apply Xypex Concentrate slurry to joint surface, including over the sealing strip, at the rate of 2.0 lb./sq.yd. (1.0 kg/m²).

Note 1: Schematic diagram shows Xypex application and waterstops. Inclusion, type and position of waterstops are at the discretion of the designer. Expanding waterstops may be placed on Xypex after it has dried or before Xypex slurry application. Xypex slurry may only be applied over waterstop if approved by waterstop manufacturer.

Note 2: Keyways may be incorporated into the joint design at the discretion of the designer.

Note 3: Schematic drawing shows Xypex Admix application. Specifier may consider the alternative use of Xypex dry shake (DS-Series) or Xypex coatings, where applicable. Refer to Xypex Standard Specifications for more information.